

## LEDA-MC B

Code: LCB0100000



Leda-MC B

### Description:

Small beacon luminaire with a 16 mm diameter and with a spring attachment. Body and embellisher manufactured in polished stainless steel AISI 316L. Diffuser in tempered glass. Suitable for installation in aggressive environments with increment weather. Provided with a 1.5 metre connection cable. 24 V AC/DC power supply. Lights up by LEDs. It includes accessories to enable operation only when connected to the mains power supply (TL safety transformer) or with the mains power on or off (PBL equipment).

### Characteristics:

Format: Leda-MC  
 Operation: Luminaire  
 Mains lamp: Cool white LED  
 Protection rating: IP65 IK07  
 Duration (h): 0

### Finishes:

LEDA wire: AS wire

### Photometry:

Luminous flux in emergency (lm): 2.4  
 Luminous flux with supply (lm): 2.4

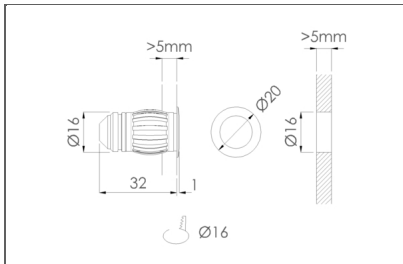

Leda-MC

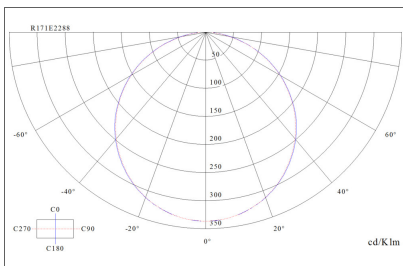

\*\*Daisalux reserves the right to change, update or remove the information contained in this document without prior warning. The selected finishes may not coincide with the displayed images.