



CC21W250-500CG/CC30W500-700CG/CC42W800-1050CG



Constant Current Driver

Model:CC42W800-1050CG



Model	Output Current	Input Current	Input Power	Output Power Range	PF	Efficiency	Output Voltage	No load Voltage
CC21W250-500CG	250mA	0.06A	13.4W	6.25-10.5W	0.92	78%	25-42V	55V
	350mA	0.07A	17.9W	8.75-14.7W	0.95	82%		
	450mA	0.10A	22.7W	11.25-18.9W		83%		
	500mA	0.11A	25.3W	12.5-21W		83%		
CC30W500-700CG	500mA	0.12A	23.5W	12.5-21W	0.92	87%	25-42V	55V
	600mA	0.14A	28.3W	15-25.2W	0.95	88%		
	650mA	0.15A	30.6W	16.25-27.3W				
CC42W800-1050CG	700mA	0.16A	33W	17.5-29.4W	0.92	88%	25-40V	55V
	800mA	0.18A	35.9W	20-32W				
	900mA	0.20A	40.4W	22.5-36W	0.95	89%	30-40V	
	950mA	0.21A	42.6W	23.75-38W				
	1050mA	0.23A	46.6W	26.25-42W				

* Test result @230V, 50Hz, Full Load.

1. Parameters

category	Item	Technical Norm
Features	Output Type	Constant Current
	IP Grade	IP20
	Insulation Class	Class II
Input	Rated Input Voltage	220-240VAC-stable
	Range of Input Voltage	198-264VAC-stable
	Range of DC Input Voltage	230-280VDC-stable
	Frequency	50/60Hz
	Input Current	≤0.28A
	Input Power	≤49W
	Power Factor	≥0.92 (230VAC, full load)
	THD	≤15% (230VAC, full load)
	No-load Power Consumption	≤0.5W @230VAC
Output	Current Accuracy	±5%
	Max. Output Power	42W
	Started Delay Time	≤0.5S (230VAC, full load)
	Current Ripple(< 120 Hz)	±5% (Imax-Imin) / (Imax+Imin)
	PstLM	≤1
	SVM	≤0.4

KGP Electronics GmbH
Hueckstraße 19
DE-58511 Lüdenscheid

KGP-V0.02

Protection	Short Circuit Protection	Auto Recovery
	Overload Protection	Auto Recovery
	No-load Protection	Auto Recovery
	Insulation voltage	I/P to O/P , 3KVac/1min
	Insulation resistance	>100M ohm @ 500VDC
	Leakage current	I/P to O/P < 250 μ A
Environment	Ta/Operation Temperature	21W,30W: -20...+50°C; 42W: -20...+45°C
	Ts/Storage Temperature	-40...+85°C
	Tc/Enclosure Temperature	75 °C
	Humidity	10%....90%RH
	Atmosphere	86-108KPa
Construction	Connection Method	Push-in Terminal
	Installation	Build-in & Independent
	PRI Wire preparation	0.75-1.5 [□]
	SEC Wire preparation	0.5-1.5 [□]
	Dimension	Independent:137.6*44*30mm (L*W*H) Built in:97.8*44*30mm(L*W*H)
Standards	Certification	ENEC/CE/SAA、EAC
	Safety Standards	EN61347-1:2015,EN61347-2-13:2014/A1:2017,E N62493:2015,AS 61347.2.13:2018, AS/NZS 61347.1:2016 Inc A1
	EMC Standards	EN55015:2019/A11:2019,EN61000-3-2:2019,EN6 1000-3-3:2013/A1:2019,EN61547:2009
	Performance	EN62384
	Surge	L-N/1KV
Others	RoHS	Complied to 2011/65/EU
	Life Time	50000h @Ta / Tc
	Warranty	5years , F.R. <10000ppm
<p>Remark: 1.All Parameters, if not specified, are measured at 230VAC/50Hz and 25°C ambient temperature. 2.LED Driver is a component of the luminaires. Luminaires and wire layout will affect the EMC, please check the EMC with end products again.</p>		

2. Connected quantities of different current Breaker

CC21W250-500CG

TYPE	Connected quantities of different current Breaker						Input Voltage	Inrush Current	Time
	current (A)	10	13	16	20	25			
	Installation wire diameter	1.5mm ²	2.5mm ²	2.5mm ²	4mm ²	4mm ²			
TYPE B		30	39	48	60	75	@230VAC	20	200
TYPE C		48	62	77	96	120			
TYPE D		77	100	123	154	192			

CC30W500-700CG

TYPE	Connected quantities of different current Breaker						Input Voltage	Inrush Current	Time
	current (A)	10	13	16	20	25			
	Installation wire diameter	1.5mm ²	2.5mm ²	2.5mm ²	4mm ²	4mm ²			
TYPE B		17	22	27	34	43	@230VAC	35	200
TYPE C		27	36	44	55	69			
TYPE D		44	57	70	88	110			

CC42W800-1050CG

TYPE	Connected quantities of different current Breaker						Input Voltage	Inrush Current	Time
	current (A)	10	13	16	20	25			
	Installation wire diameter	1.5mm ²	2.5mm ²	2.5mm ²	4mm ²	4mm ²			
TYPE B		15	20	24	30	38	@230VAC	40	200
TYPE C		24	31	38	48	60			
TYPE D		38	50	61	77	96			

3. Label



KGP CC30W500-700CG
 KGP Electronics GmbH
 Hueckstraße 19
 DE-58511 Lüdenscheid
 Constant Current LED Power Supply
 ● $t_c=75^\circ\text{C}$

PIN1	PIN2	I _{rated} [mA]	P _{rated} [W]	U _{rated} [V]	U _{in} / f _{in}	η [W]	ta [°C]	λ
OFF	OFF	500	21	25-42	220-240V 50/60Hz	0.12	-20...+40	0.92C
OFF	ON	600	25					
ON	OFF	850	27					
ON	ON	700	30					

0.5-1.5□
8-9mm

No load: 55VDC Max.
OFF → ON

1
2

N PRI
L PRI

SELV EN 17 CE For LED Only

0.75-1.5□
8-9mm

KGP CC42W800-1050CG
 KGP Electronics GmbH
 Hueckstraße 19
 DE-58511 Lüdenscheid
 Constant Current LED Power Supply
 ● $t_c=75^\circ\text{C}$

PIN1	PIN2	I _{rated} [mA]	P _{rated} [W]	U _{rated} [V]	U _{in} / f _{in}	η [W]	ta [°C]	λ
OFF	OFF	800	32	25-40	220-240V 50/60Hz	0.18	-20...+40	0.92C
OFF	ON	900	36					
ON	OFF	950	38					
ON	ON	1050	42					

0.5-1.5□
8-9mm

No load: 55VDC Max.
OFF → ON

1
2

N PRI
L PRI

SELV EN 17 CE For LED Only

0.75-1.5□
8-9mm

4. Dimension (Unit: mm)

Independent type:

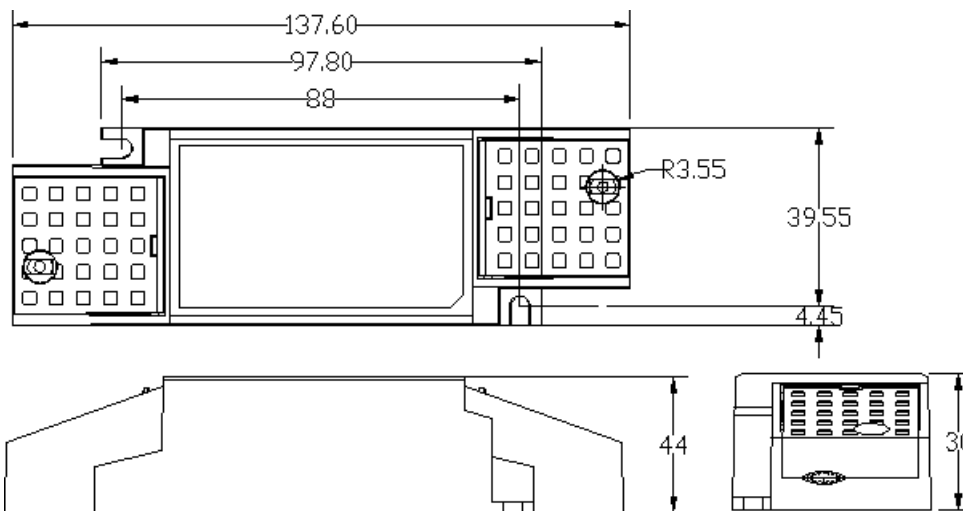

Built in type:

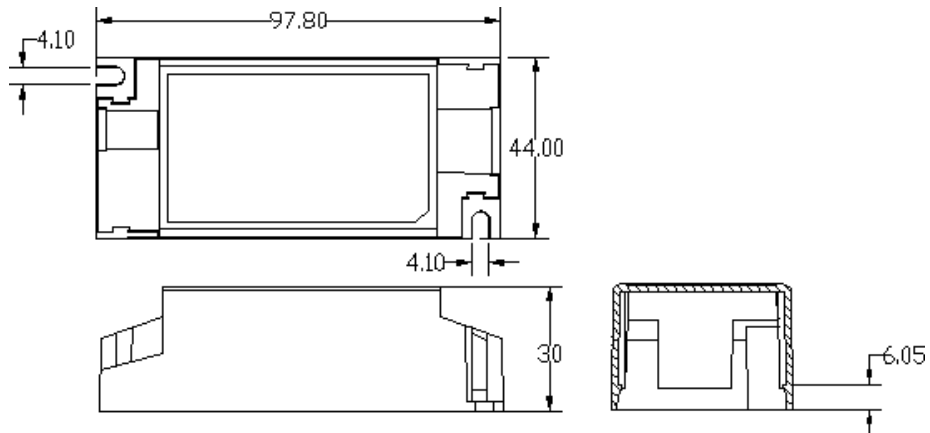

5. Packing information

Carton L*W*H(mm)	Pcs/Carton	Net weight/ Pcs(kg)	Net weight/ Carton(kg)	Gross weight / Carton(kg)
450*240*200	85	0.124	10.54	11.29

6. Wiring Diagram

Independent type:

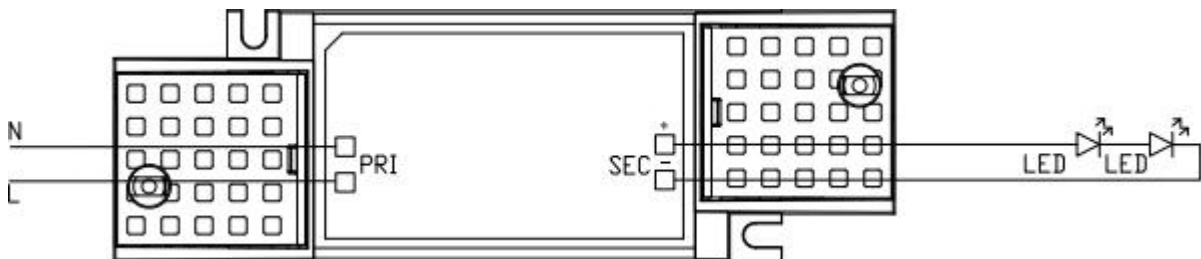

Built in type:

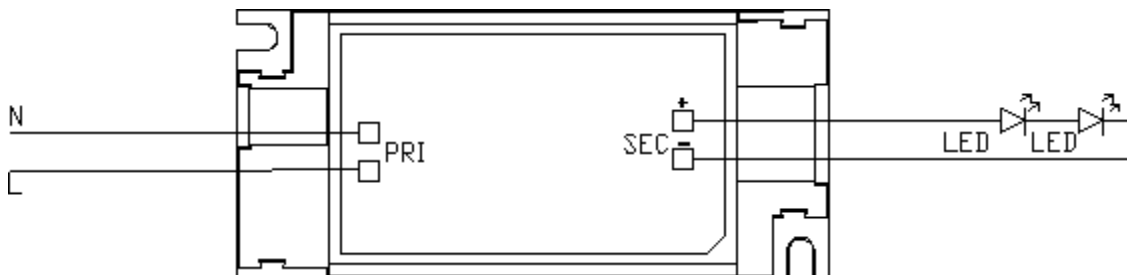

7. Wiring instructions

- All connections must be kept as short as possible to ensure good EMI behaviour
- Mains leads should be kept apart from LED Driver and other leads (ideally 5 – 10 cm distance)
- Advice the maximum length of output wires is 3 m
- Secondary switching is not permitted (Except for constant voltage)
- Incorrect wiring can damage LED modules.
- The wiring must be protected against short circuits to earth (sharp edged metals parts, metal cable clips, louver, etc.)