

Geometry Suspended Adjustable 672x672 1x LED DE

137501XX

⚠️ FIXTURE MUST BE COMBINED WITH 'SUSPENSION KIT' & 'POWER FEED' - NOT INCLUDED

SUSPENSION KIT

110610XX - Suspension Kit Geometry Suspended Adjustable 672x672/672x1288 4m
110611XX - Suspension Kit Geometry Suspended Adjustable 672x672/672x1288 8m



POWER FEED

137200XX - Power Feed Recessed 2m
137201XX - Power Feed Recessed 6m



137202XX - Power Feed Surface 2m
137203XX - Power Feed Surface 6m



1

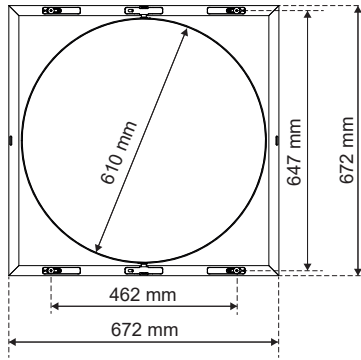

ELECTRICAL SPECS LED-FIXTURE

Voltage (V)	Power (W)
24	21
+ RED	- BLACK
For parallel connection, respect polarity! Not suited for connection to mains voltage. Combine with a Modular LED-driver.	

2

Optionally use included printed template to mark all 4 suspension point positions. Use suitable paper tape to attach template to the ceiling

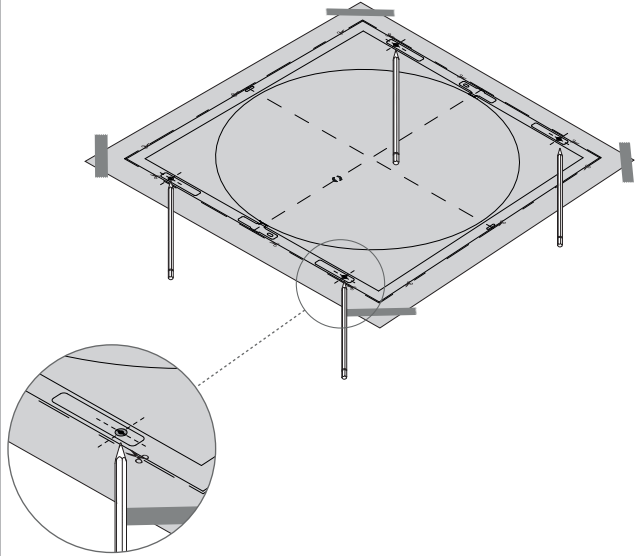

3

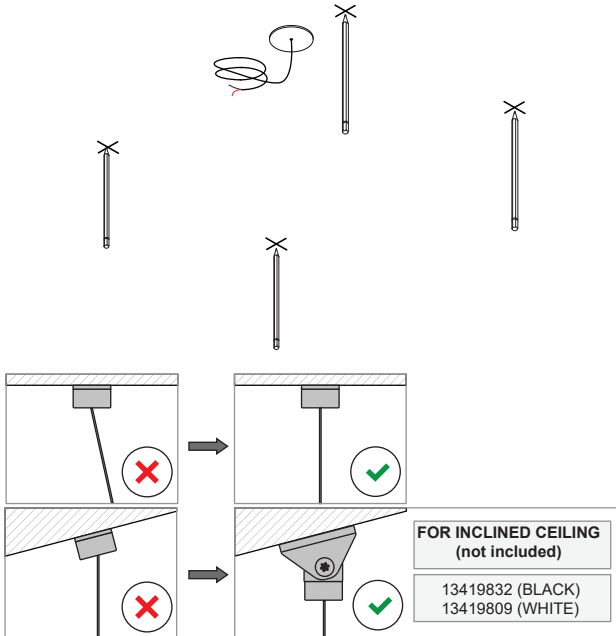

FOR INCLINED CEILING (not included)

13419832 (BLACK)
13419809 (WHITE)

4

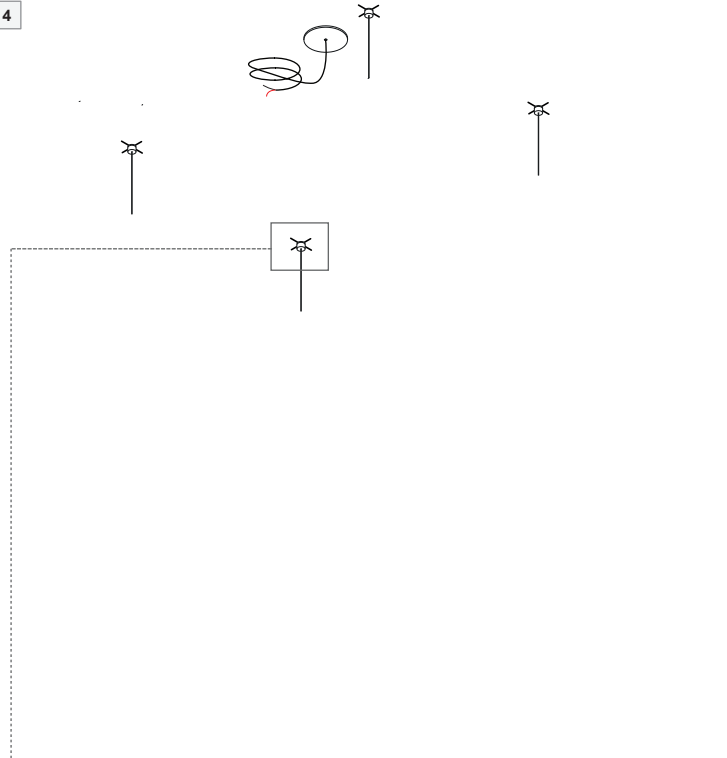

LIGHT SOURCE - DO NOT TOUCH LED

Touching the LED can result in permanent damage of the light source. The light source and/or driver contained in this luminaire shall only be replaced by the manufacturer or his service agent or a similar qualified person.



PREVENTING ELECTROSTATIC DAMAGE

A discharge of static electricity may damage sensitive components. Therefore do not touch the LED nor the stripped parts of the wires with bare hands. Always be properly insulated by using ESD gloves.

DRIVERS & ACCESSORIES

For latest version of driver matrix and available accessories check www.supermodular.com or connect with your sales contact.

02 - 08/01/2024

