

# PLANO PETIT 1.0

INSTALLATION INSTRUCTIONS | APRIL 2023

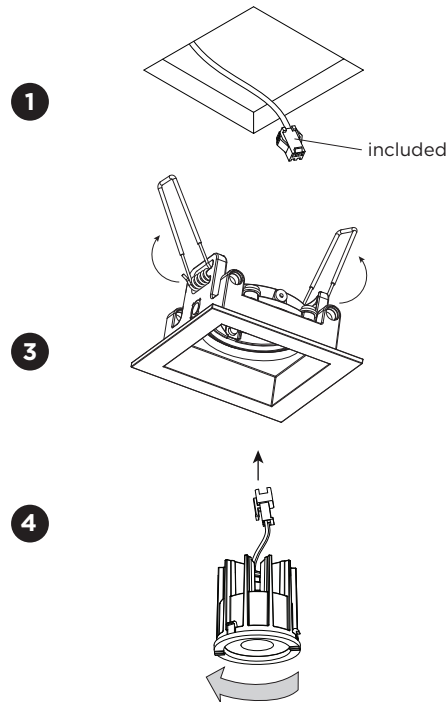

side view

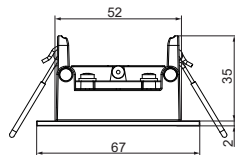

bottom view

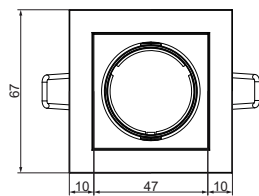

## DIMENSIONS



## MOUNTING INSTRUCTION

- 1 Make a hole in the ceiling according to the prescribed dimensions.
- 2 **POWER CONNECTION**  
Always use a driver according to the specifications of the LED module.  
**SERIAL CONNECTION - for LED**
- 3 Push the springs upwards and insert the fixture in the ceiling hole.
- 4 Connect the plugs and lock the LED module into the housing by a quarter turn clockwise.

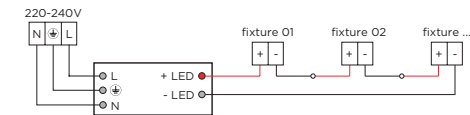

Driver must be powered off before connecting the cables.

Before connecting the luminaire/LED module to the driver please make sure the driver is not powered but disconnected from the mains. The driver can only be powered when the luminaire/LED module is already connected. Disregarding this instruction might damage or even destroy the luminaire/LED module.

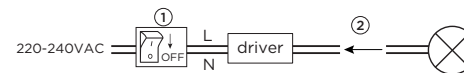

# PLANO PETIT 1.0

INSTALLATION INSTRUCTIONS | APRIL 2023

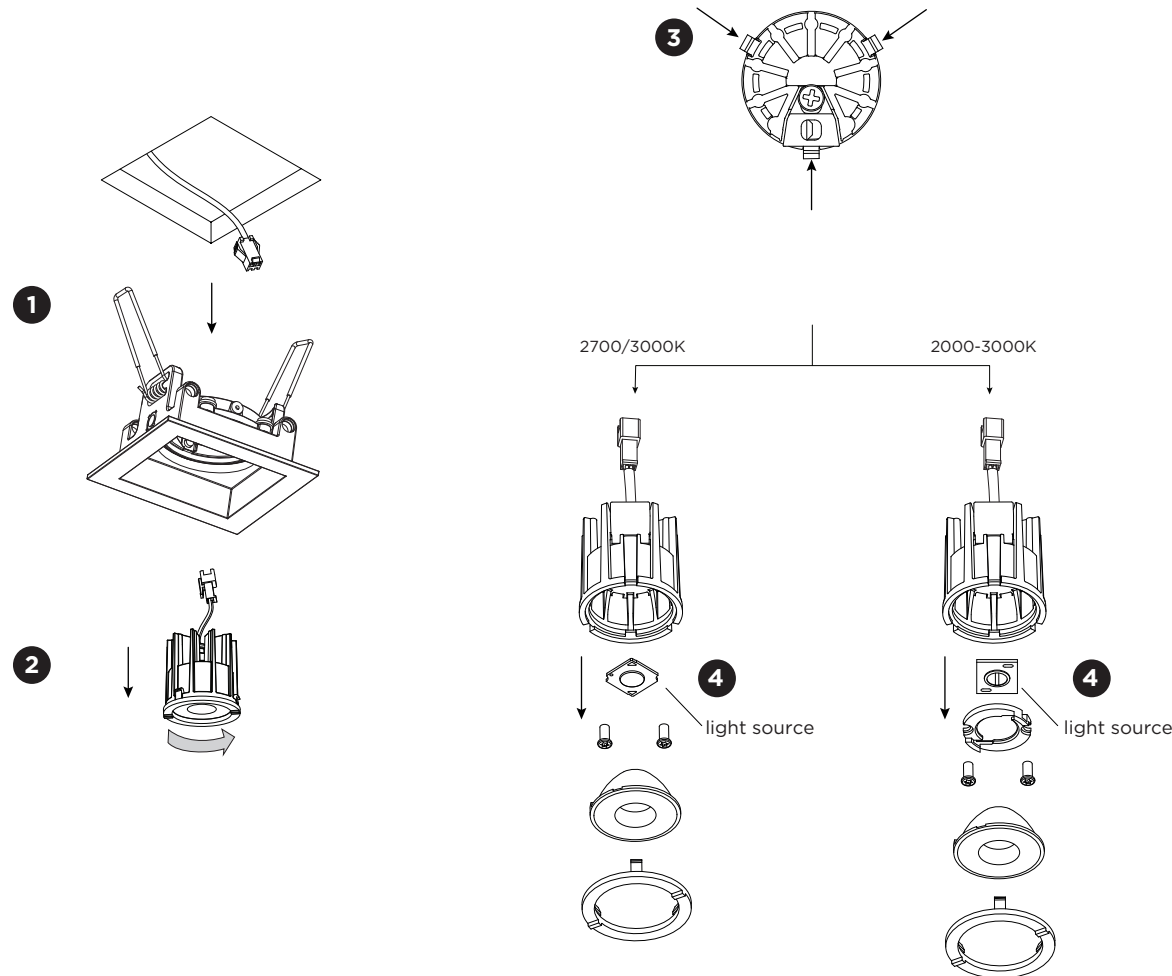

## DISMOUNTING AND RECYCLING INSTRUCTIONS

### Light source

- 1 Take the luminaire out of the ceiling hole and unplug the connector.
- 2 Turn the LED module by a quarter counter clockwise to pull it out.
- 3 Push at the three points to loosen the front ring.
- 4 Take out the lens and unscrew the holder or light source to remove the light source.

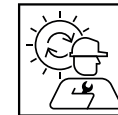

The light source is replaceable by an authorized professional.  
For advice contact your Wever & Ducré customer service contact point.



This luminaire contains a light source with the energy class E.