

## Installation instructions



Lamp body: 1pcs



Lamp head: 1pcs



Plastic cover: 1pcs



Silicone pad



Wall mount: 1pcs



Sliding block: 1pcs



FLAT gasket: 1pcs



Spring washer: 1pcs



Screw: 1pcs



Plastic anchors: 4pcs



Screw: 4pcs



Spanner: 8mm, 5mm & 2mm

1

Open the box and identify the various lamp accessories.

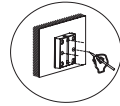
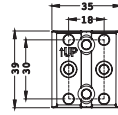
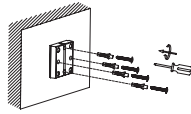

A

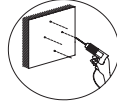

B

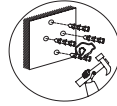

C

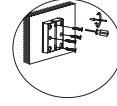

D

2

- A. Fix the wall mount on the wall and mark the drilling points for the screws.
- B. Drill into the marked drilling points using a  $\text{Ø}6\text{mm}$  drill bit.
- C. Fix the installation colloidal particles in the installation hole.
- D. Use a screw driver to fix the flat head cross tapping screws to the wall.

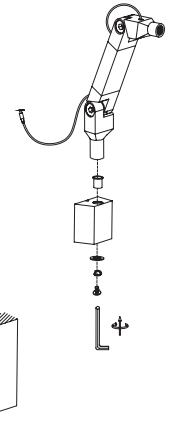

3

Install the lamp body, plastic cover, wall mount, flat gasket, spring washers, cylindrical head hexagon screws, with 5mm spanner to lock them successively.

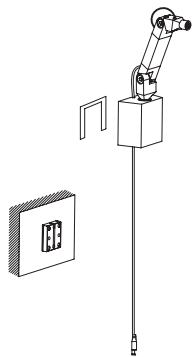

4

- A. Straighten the thread, insert it into the thread groove of the slide block, and then attach the silicone pad.
- B. Then insert the slider into the wall mount.

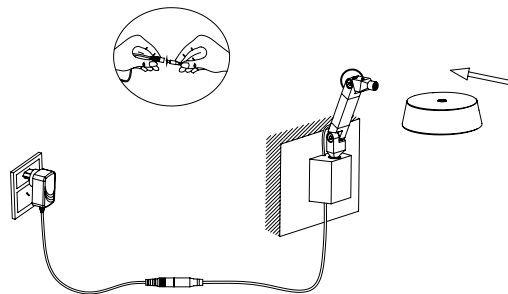

5

- A. Insert the lamp head into the lamp body
- B. Connect the cable female and male connector.

6

Plug in the power, touch the center of the lamp holder to light up, long press to adjust brightness. The lamp has a memory function, meaning it can remember your last light intensity when turned off and on again

# DARK Collection

DARK is quintessentially an example of the maxim "form follows function". Precision workmanship, high-quality materials and precisely worked details such as the seamlessly integrated hinge design gives the collection its elegance.

The tapered angles give the lamp a more 3-dimensional expression, which has over the years become the iconic signature for LIGHT-POINT products.



## DARK W1

### User Instructions

#### General use

- The product is designed for indoor use only.
- The lamp gets hot after prolonged use, therefore, do not cover the product.

#### Cleaning instructions

- Before cleaning, ensure that the power supply is switched off.
- Wipe surface of lamp shade with a soft cloth.
- Do not use any abrasive cleaning tools such as steel wool, scouring sponges or stiff brushes.
- Never use strong cleaning agents such as white spirit, household glass cleaner or cellulose thinners.

#### Safety precautions

- The appliance should be installed, connected and tested by qualified electrician and in accordance with local regulations.
- Turn off the power supply before installation or maintenance of the lamp, and make sure that the cables are not squeezed or damaged by sharp edges during installation.
- The lamp should not be covered by insulation blankets or similar materials.

#### International warranty

Your product has gone through rigorous testing in order to live up to the highest quality standards. It therefore carries a 7-year warranty from the date of the original retail purchase receipt, covering defects in materials and workmanship when used normally in accordance with the published LIGHT-POINT guidelines.

These guidelines include but are not limited to information contained in technical specifications, safety instructions and quick start guides. LIGHT-POINT is not responsible for damage arising from failure to follow instructions relating to the use of the product.

LIGHT-POINT is a registered trademark of NORDIC LIVING GROUP.

For more information, please visit  
**LIGHT-POINT.COM**