

TUBE

Design by Ichiro Iwasaki.

Reference

6115.

Application

Ceiling Lamps

Installation type

Surface

Description

Ceiling lamp with three shades of different sizes. Featuring a curved sheet aluminium shade lending a visual and material lightweight quality.

Diffuser

Polycarbonate diffuser

Materials

LED support: Aluminum

Ceiling rose: Steel

Finish



6115-10 White (Tube NCS S 0300-N)



6115-71 Grey L2, Grey M1, Grey D1 (NCS S 2500-N, S 4500-N, S 7000-N)

Sketch

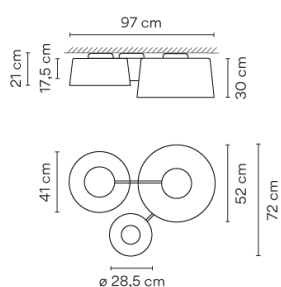

Electrical characteristics

1 x LED PLATE 25W 700mA

AND

1 x LED PLATE 20W 700mA

AND

1 x LED PLATE 13,5W 700mA



Total 58.5 W



Light source: 2700K CRI >90 8120 lm 138 lm/W

Driver included: CC - Constant Current 700 mA 110-240V 50/60Hz

Electronic dimming DALI 1-10V Push

Technical characteristics

- Main input by the biggest shade

Physical characteristics

2 Box / 0.00 x 0.00 x 0.00 m. / Vol. 0.2148 m³ /

Gross weight 17.2 kg. / Net weight 4.7 kg.

Installation and assembly

Please, see the installation manual

Light distribution

General lighting

Lamp for general lighting that equally distributes the light in all directions.

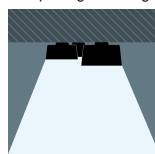

Photometric data

Certificates

