

BUTTON HL

Designed by Piero Lissoni, 2005

F3190009

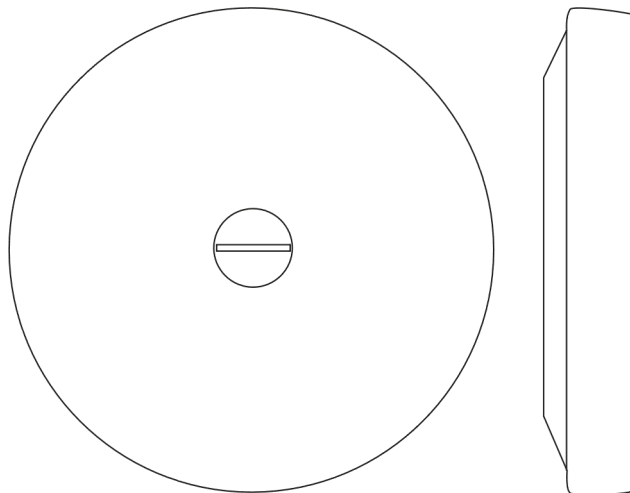

BUTTON HL

F3190009

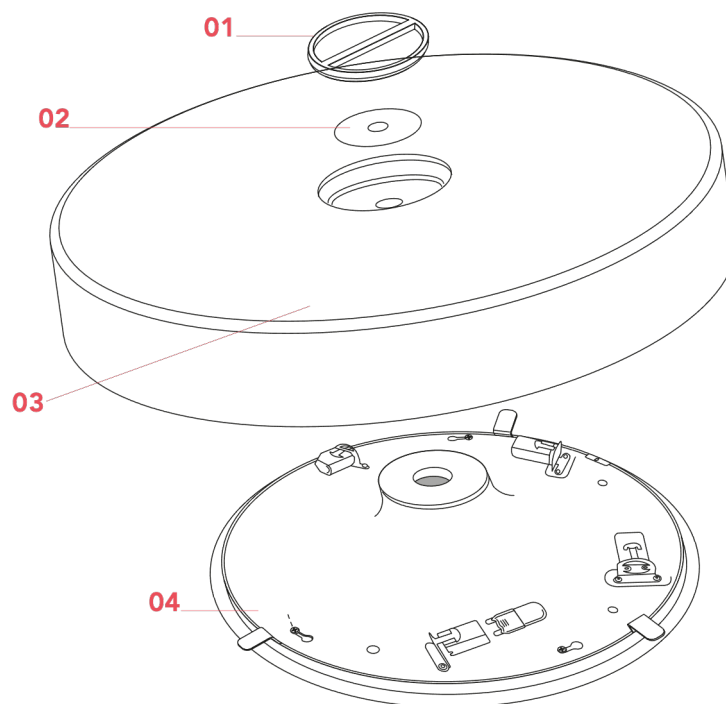
EN

- 01. RF3190100 – Chrome locking cap assembly
- 02. RF15719 – Silicone gasket shore 70
- 03. RF3190300 – Opal glass diffuser (for new version)
- 04. RF15709 – G9 Lamp holder

BUTTON HL F3190009

EN

RF3190100

CHROME LOCKING CAP ASSEMBLY



WARNING! When installing and whenever acting on the appliance, ensure that the power supply has been switched off.
For the installation of the spare-part, it is necessary to consult a qualified electrician.

©2021 Flos - All rights reserved - www.flos.com
Flos reserves the right to introduce any changes to its own models, without prior notice.

BUTTON HL F3190009

EN

RF3190100

CHROME LOCKING CAP ASSEMBLY

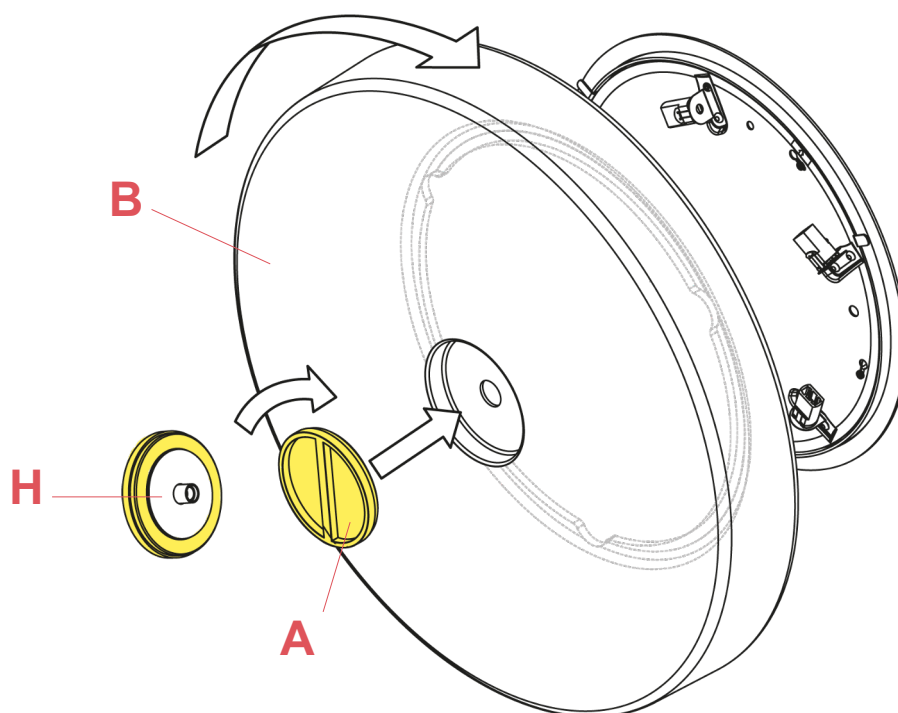

Fig.1

Position the diffuser (B) to the lamp onto the lamp structure. Ensure that the gasket (H) is located correctly on the cap (A). Lock the diffuser to the lamp structure by rotating the cap (A) clockwise.

WARNING! When installing and whenever acting on the appliance, ensure that the power supply has been switched off. For the installation of the spare-part, it is necessary to consult a qualified electrician.

BUTTON HL F3190009

EN

RF15719

SILICONE GASKET SHORE 70



WARNING! When installing and whenever acting on the appliance, ensure that the power supply has been switched off.
For the installation of the spare-part, it is necessary to consult a qualified electrician.

©2021 Flos - All rights reserved - www.flos.com

Flos reserves the right to introduce any changes to its own models, without prior notice.

BUTTON HL F3190009

EN

RF15719

SILICONE GASKET SHORE 70

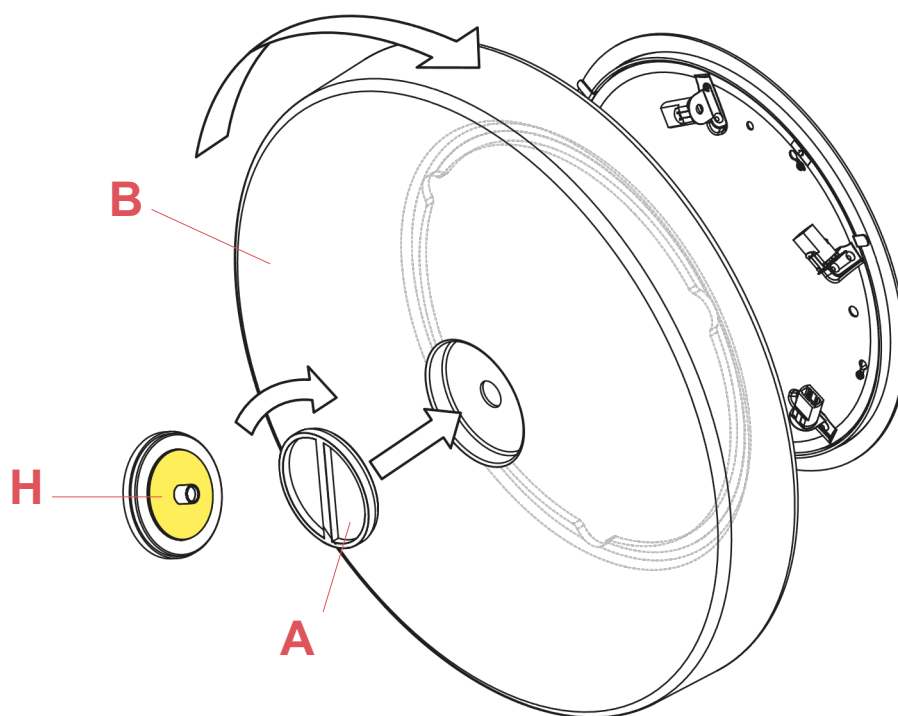

Fig.1

Position the diffuser (B) to the lamp onto the lamp structure. Ensure that the gasket (H) is located correctly on the frieze (A). Lock the diffuser to the lamp structure by rotating the frieze (A) clockwise.

WARNING! When installing and whenever acting on the appliance, ensure that the power supply has been switched off. For the installation of the spare-part, it is necessary to consult a qualified electrician.

BUTTON HL F3190009

EN

RF3190300

OPAL GLASS DIFFUSER FOR NEW VERSION



WARNING! When installing and whenever acting on the appliance, ensure that the power supply has been switched off.
For the installation of the spare-part, it is necessary to consult a qualified electrician.

©2021 Flos - All rights reserved - www.flos.com
Flos reserves the right to introduce any changes to its own models, without prior notice.

BUTTON HL F3190009

EN

RF3190300

OPAL GLASS DIFFUSER FOR NEW VERSION

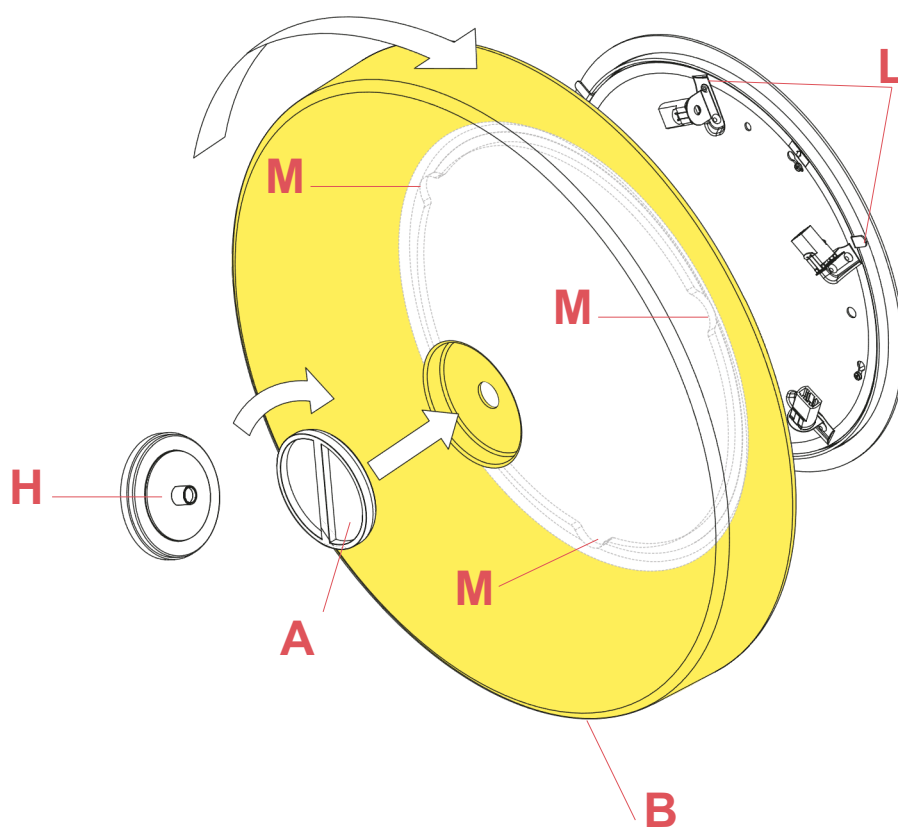

Fig.1

Assemble the diffuser (B) positioning it with the three openings (M) on the safety brackets (L), then rotate it approximately 60° clockwise. Fasten the frieze (A) ensuring before that the gasket (H) is correctly positioned.

WARNING! When installing and whenever acting on the appliance, ensure that the power supply has been switched off. For the installation of the spare-part, it is necessary to consult a qualified electrician.

BUTTON HL F3190009

EN

RF15709

G9 LAMP HOLDER

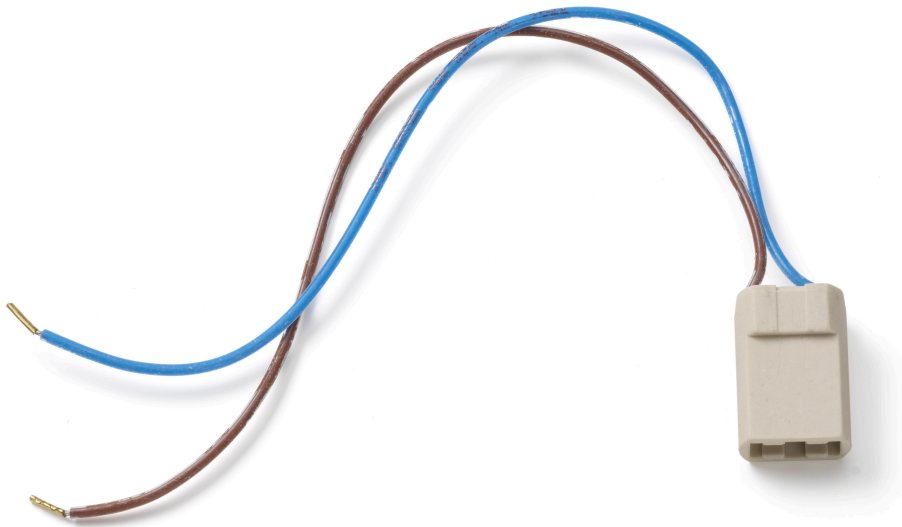

WARNING! When installing and whenever acting on the appliance, ensure that the power supply has been switched off.
For the installation of the spare-part, it is necessary to consult a qualified electrician.

©2021 Flos - All rights reserved - www.flos.com
Flos reserves the right to introduce any changes to its own models, without prior notice.

BUTTON HL F3190009

EN

RF15709

G9 LAMP HOLDER

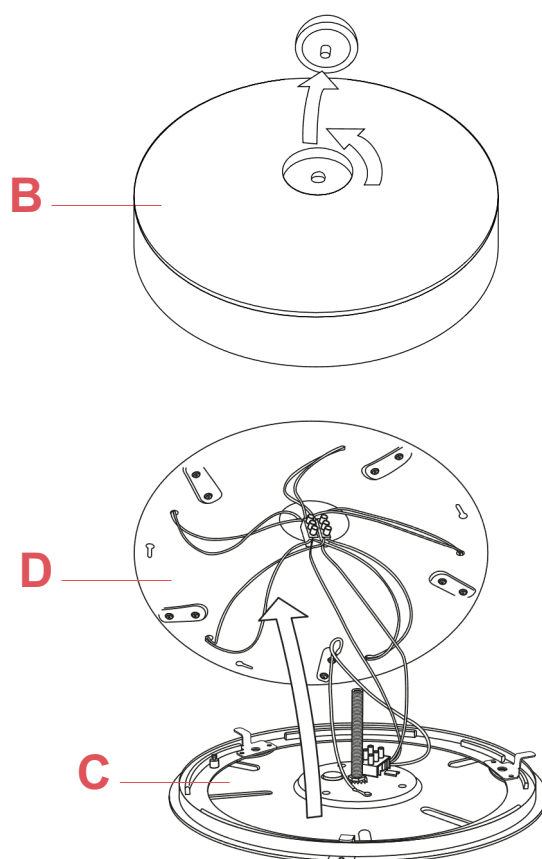

Fig.1

Unscrew the frieze (A) and remove the glass diffuser (B);
Separate the wall mounting (C) from the lamp body (D).

WARNING! When installing and whenever acting on the appliance, ensure that the power supply has been switched off.
For the installation of the spare-part, it is necessary to consult a qualified electrician.

BUTTON HL F3190009

EN

RF15709

G9 LAMP HOLDER

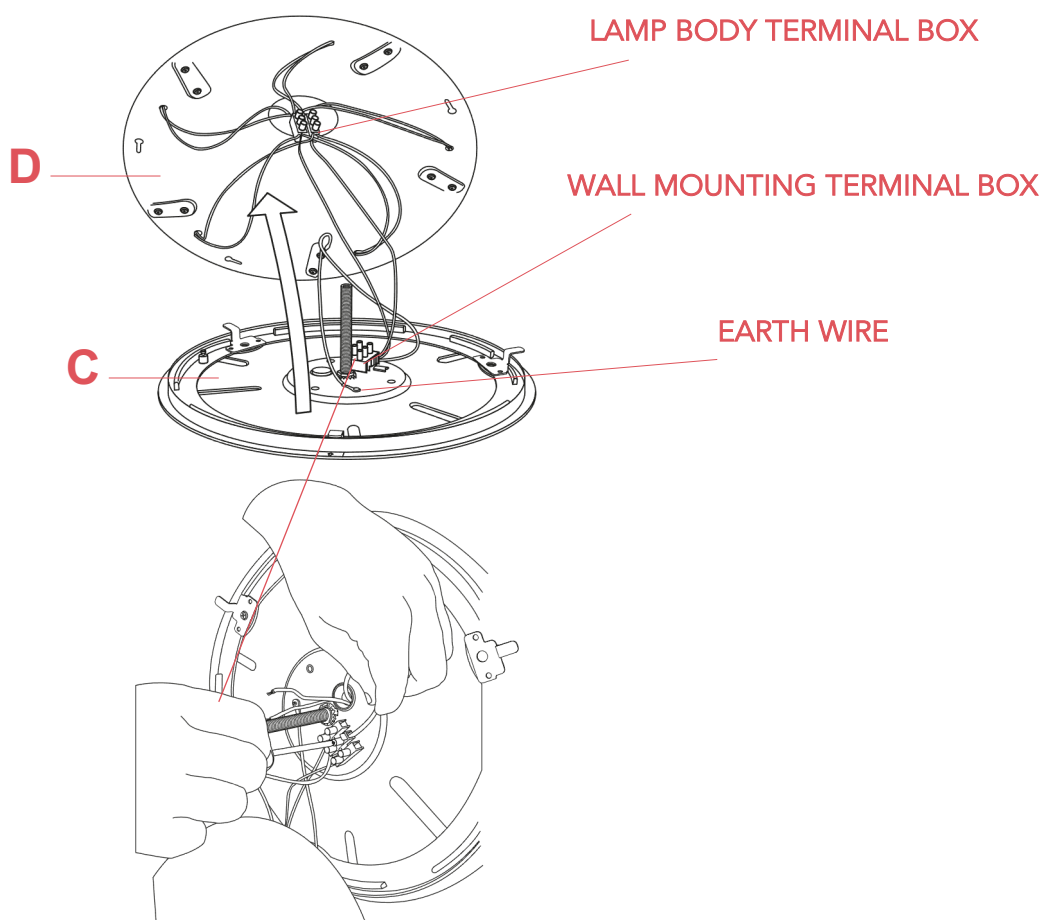

Fig.2

Disconnect the main power supply electrical wires (electrical wires that come-out from the clients wall or ceiling) from the wall mounting (C) terminal box;

Disconnect the earth wire on the wall mounting (C) by unfastening the screw;

Disconnect from the terminal box present on the wall mounting the wires that go to the other terminal box present on the lamp body (D).

WARNING! When installing and whenever acting on the appliance, ensure that the power supply has been switched off. For the installation of the spare-part, it is necessary to consult a qualified electrician.

BUTTON HL F3190009

EN

RF15709

G9 LAMP HOLDER

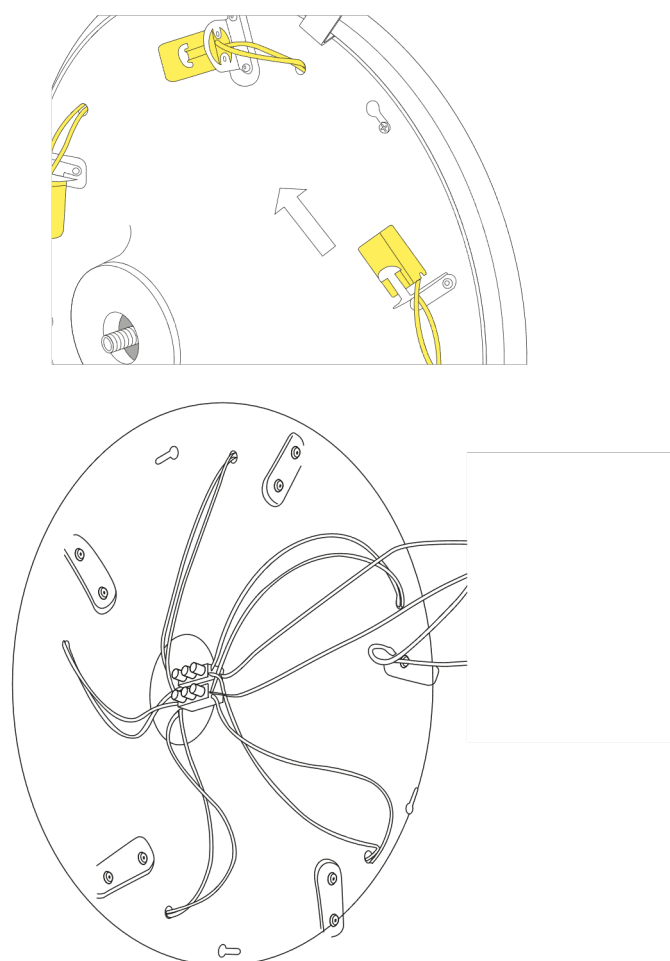

Fig.3

Point-out the wires of the damaged lamp holder and disconnect the wires from the terminal box; Remove the lamp holder with wires by slipping the wires out from the hole.

Replace the G9 fitting lamp holder.

WARNING! When installing and whenever acting on the appliance, ensure that the power supply has been switched off. For the installation of the spare-part, it is necessary to consult a qualified electrician.