

FLOS

■ F9550030 Black

Wan Ceiling/Wall

Designed by Johanna Grawunder, 2005



Halogen

Wall or ceiling fixture providing direct lighting. Aluminum body, available in shiny white, shiny black and shiny green finishes. Low glare shield. Provided by two different ring due to block the safety tempered glass, in black and green.

Are you a professional and your project needs consulting and support?

[BOOK AN APPOINTMENT](#)

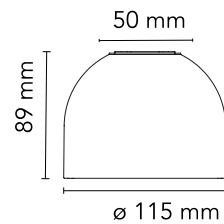

Main specifications

| | |
|-------------------|--------------------------|
| Mounting | Ceiling and wall surface |
| Environments | Indoor dry location |
| Light Source Type | Bulb |
| Lamp category | Halogen |
| Lamp holders | G9 |
| Ilcos | HSG |
| Number of heads | 1 |

Physical

| | |
|---------------------|-------|
| Colour | Black |
| Net weight (kg) | 0.62 |
| Package height (mm) | 175 |
| Package width (mm) | 220 |
| Package length (mm) | 190 |
| Package volume (m3) | 0.01 |

Download

[Mounting instructions](#)  PDF

[Spare Parts](#)  PDF

Photometric Files

[LDT / IES](#)  LDT

Technical Drawings

[2D](#)  ZIP

[3D](#)  ZIP



Schematic light drawing

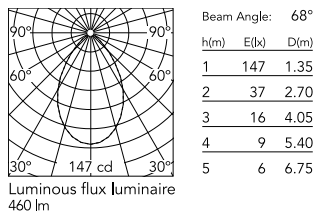

Photometric

| | |
|--------------------|-----------|
| Light distribution | Symmetric |
| Extreme cut off | No |

Electrical

| | |
|----------------------|--|
| Insulation class | II |
| Frequency (Hz) | 50/60 |
| Main voltage (Vac) | 220-250 |
| LED voltage Vf (Vdc) | null |
| Dimmable | Yes |
| Dimming interface | Remote Dimmable (Dimmer Not Included) |
| Batteries inside | No |

Bulbs



NOT INCLUDED

RF18863

Halogen Lamp G9 33W 2700K

HALOPIN Dimmable

Spare Parts

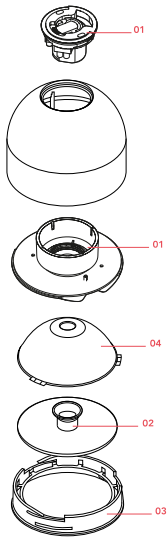

- | | | |
|-----|--|-----------|
| 01. | New type attachment assembly with g9 lamp holder and safety ring | RF9550300 |
| 02. | Wan glass assembly | RF9550200 |
| 03. | External ring | RF13990 |
| 04. | Reflector / ring assembly | RF9550130 |

DOWNLOAD



RF9550300

New type attachment assembly
with g9 lamp holder and safety
ring



RF9550200

Wan glass assembly



RF13990

External ring



RF9550130

Reflector / ring assembly