



## SPYCO ON 2 Hi B

414 353 20 B

AVAILABLE IN

**BLACK** 414 353 20 B

**WHITE** 414 353 20 W

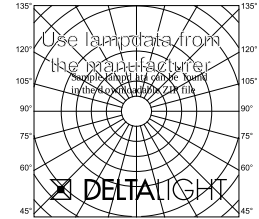
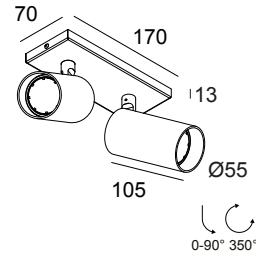

 [View on website](#)

### General info

<b>LOCATION</b>	indoor
<b>INSTALLATION</b>	Ceiling Surface mounted
<b>INGRESS PROTECTION</b>	IP20
<b>WEIGHT (KG)</b>	0.7
<b>ADJUSTABILITY</b>	0° to 90° swiveling, 350° rotatable

### Electrical info

	2 x QPAR51 max.20W
<b>CLASS</b>	II
<b>DIM TYPE</b>	mains (phase cut-off)

### Lightsource info

<b>LIGHTSOURCE NAME</b>	GU10
-------------------------	------

### Remarks

lamp not included

For detailed installation instructions, please consult the manual: [414\\_353\\_20\\_HAND.pdf](#)

Notes: