

installation for 2.0 / 4.0

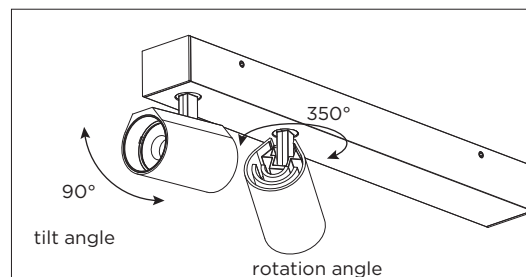

DIMENSIONS

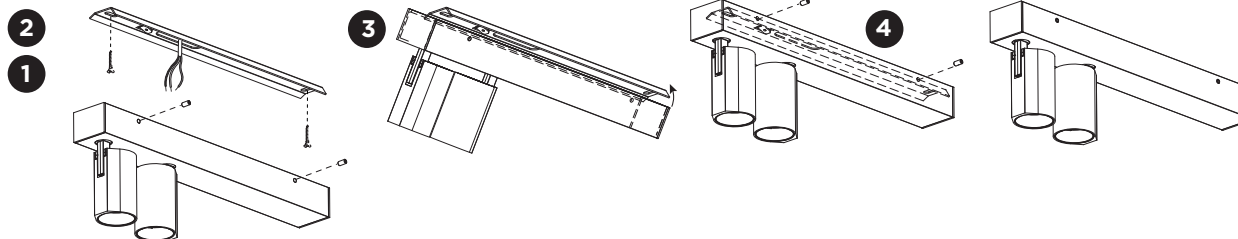
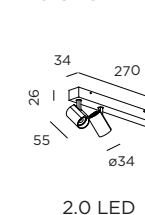

2.0 LED

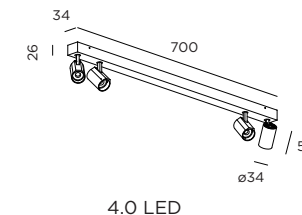

4.0 LED

MOUNTING INSTRUCTION

- 1 Remove the mounting base from the luminaire by loosening the socket screws and mount it on the ceiling with screws (screws are not included).
- 2 POWER CONNECTION
Connect to 220-240V.
Connect the ceiling base earth cable.
- 3 Attach the luminaire to the mounting base with the screw opposite side first and tilt towards the ceiling as shown.
- 4 Fixate the luminaire on the base with the socket screw.

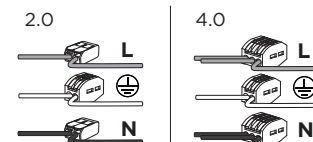

Mounting base:

front view

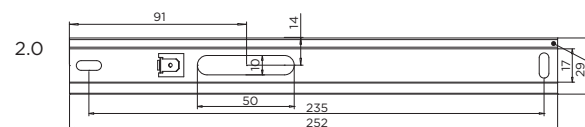

4.0

front view

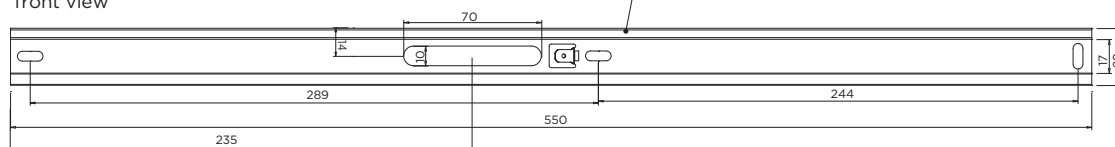

side view



The screws are on the upper side.