

HEXO

17-Dec.-2016

1.0 LED

LED 8W | 220-240VAC | 50-60Hz | COB 2-step | incl. PS | phase-cut dim

CE IP20 0.3m 36°

white texture	146564W_
gold	146564G_
bronze	146564Q_
copper	146564P_
black texture	146564B_

LIGHT COLOUR

2700K >80CRI 600lm	2
3000K >80CRI 600lm	4
1800-2850K >90CRI 410lm	9

1.0 PAR16

PAR16 max. 35W | GU10 | 100-240VAC | 50-60Hz

CE IP20 0.9m

white texture	146520W0
gold	146520G0
bronze	146520Q0
copper	146520P0
black texture	146520B0

OPTIONAL

for PAR16 lamps see our catalogue

OPTIONAL

single inner cover max. 10W

white texture	911031W1
gold	911031G1
black texture	911031B1

base plate dimensions

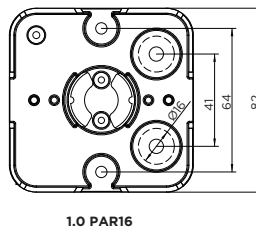
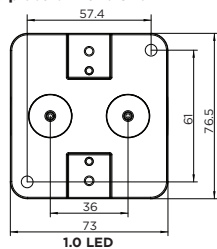

1.0 LED

1.0 PAR16

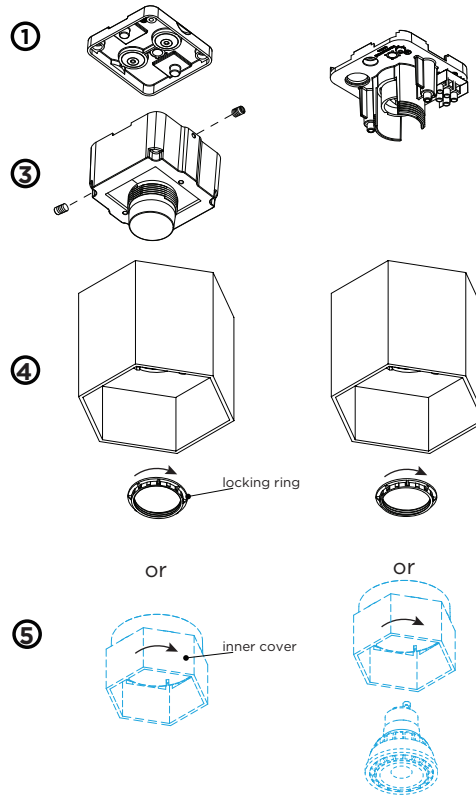

DIMENSIONS

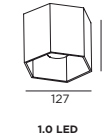

1.0 LED

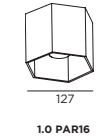

1.0 PAR16

1 MOUNTING INSTRUCTION

Remove the screws of the top part, put the cables through the opening and mount the base on the ceiling.

2 POWER CONNECTION

Connect wiring to the power supply (for LED) or to terminal block (for PAR16)
interior connection: STANDARD version

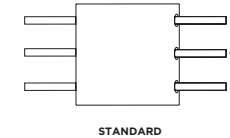

STANDARD

3 FOR LED

Attach the LED housing on the base by two allen screws.

4 FOR LED

Attach the HEXO cover to the LED housing by screwing the locking ring

FOR PAR16

Attach the HEXO cover to the base by screwing the locking ring

5 OPTIONAL inner cover

put the inner cover in the outer cover by screwing.

with inner cover: **max. 10W**

when using the inner cover you don't need the locking ring.



WEVER & DUCRÉ
LIGHTING

www.weverducre.com

Wever & Ducre bvba Kwadestraat 153 bus 2.1 8800 Roeselare

INSTALLATION
INSTRUCTIONS