

# WIRO SINGLE DECENTER SET

INSTALLATION INSTRUCTIONS | MAY 2023

Mounting base:

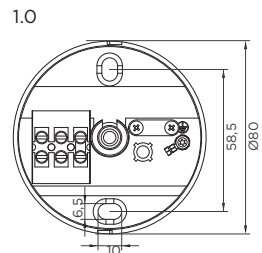

2.0|3.0|4.0

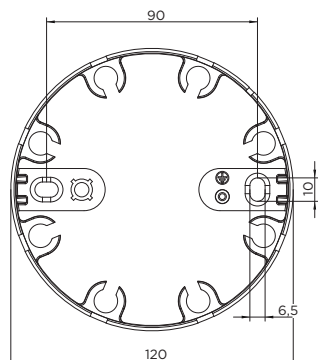

installation of 1.0.

dimension for the inner piece of the cable holder:

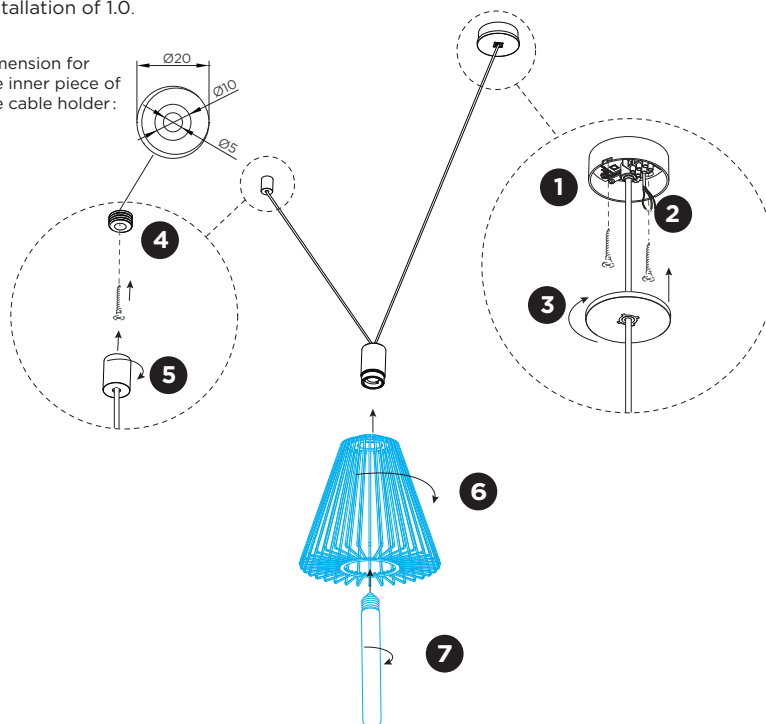

DIMENSIONS

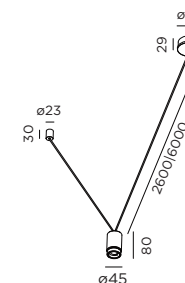

1.0

MOUNTING INSTRUCTION

**1** Remove the cover of the mounting base and mount the base on the ceiling with screws (screws are not included).

**2** POWER CONNECTION

Connect to 220-240V.

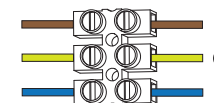

**3** Mount the ceiling cover back on the ceiling base by aligning the clips in the groove and turning clock wise.

**4** Screw out the inner piece of the cable holder and fix it on the ceiling with a screw (screw is not included).

**5** Screw the cable holder back to the inner piece.

**6** Mount the shade on the fixture by turning clockwise.

**7** Mount the bulb.

This suspension set can be applied to several Wiro shades.  
Such as:

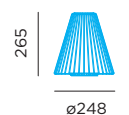

Shade of  
1.0 CONE



Shade of  
2.0 WIRO



Shade of  
1.8 WIRO

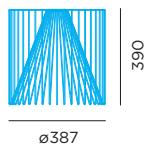

Shade of  
3.8 WIRO

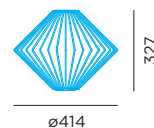

Shade of  
1.1 DIAMOND



Shade of  
4.0 GLOBE

for installation of 2.0|3.0|4.0, please find the details on page 2

# WIRO SINGLE DECENTER SET

INSTALLATION INSTRUCTIONS | MAY 2023

installation of 2.0|3.0|4.0

dimension for the inner piece of the cable holder:

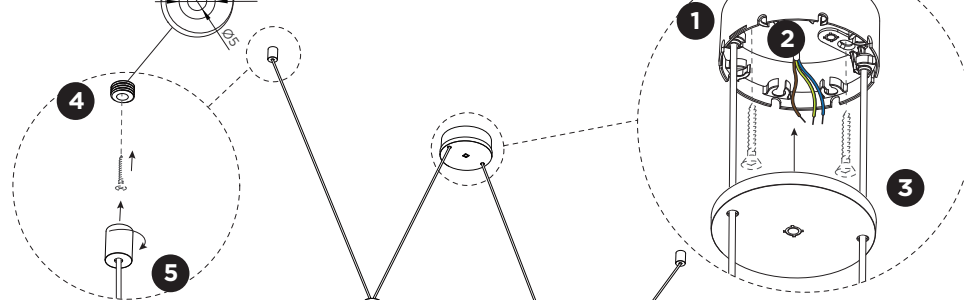
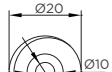

## DIMENSIONS

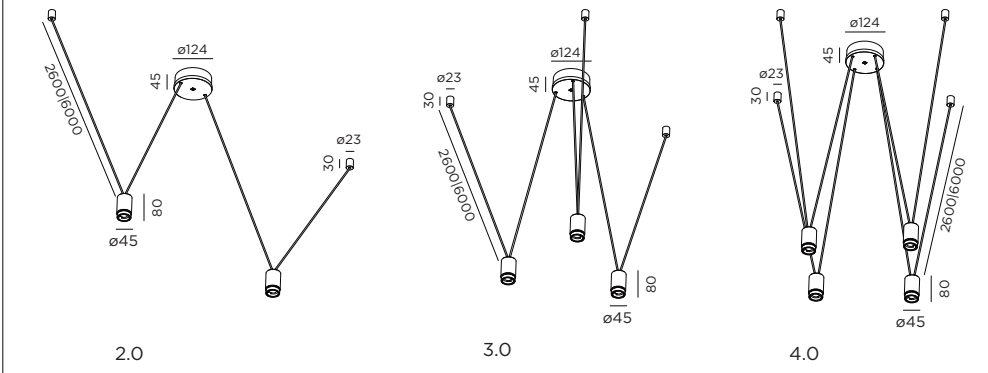

**WARNING:** the slot A and raised section B should be aligned when installing.

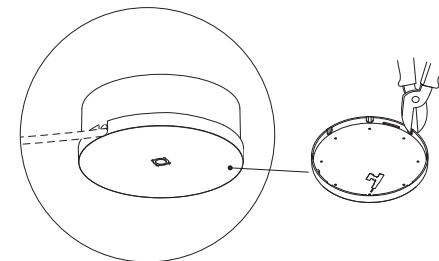
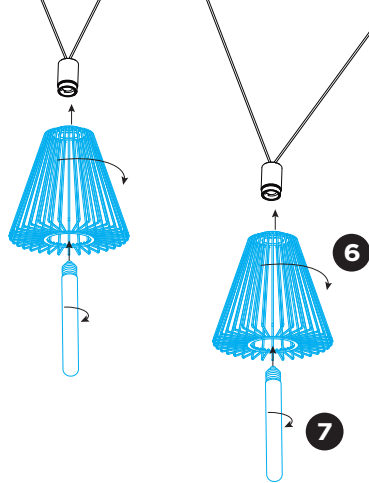
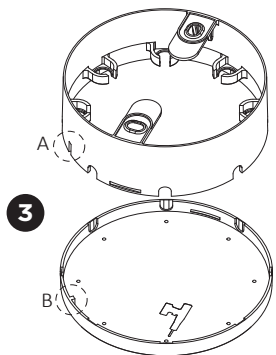

**Option 1:** The cable leaves the ceiling base at the side.

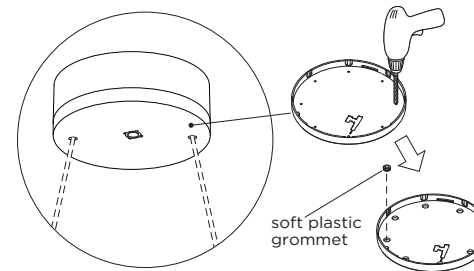

**Option 2:** The cable leaves the ceiling base at the front (side) of the cover.

## MOUNTING INSTRUCTION

- Remove the cover of the mounting base and mount the base on the ceiling with screws (screws are not included).
- POWER CONNECTION**  
Connect to 220-240V.  

2.0	3.0	4.0
- Mount the ceiling cover back on the ceiling base by aligning slot A and raised section B (see the WARNING illustration for details).
- Screw out the inner piece of the cable holder and fix it on the ceiling with a screw (screw is not included).
- Screw the cable holder back to the inner piece.
- Mount the shade on the fixture by turning clockwise.
- Mount the bulb.