

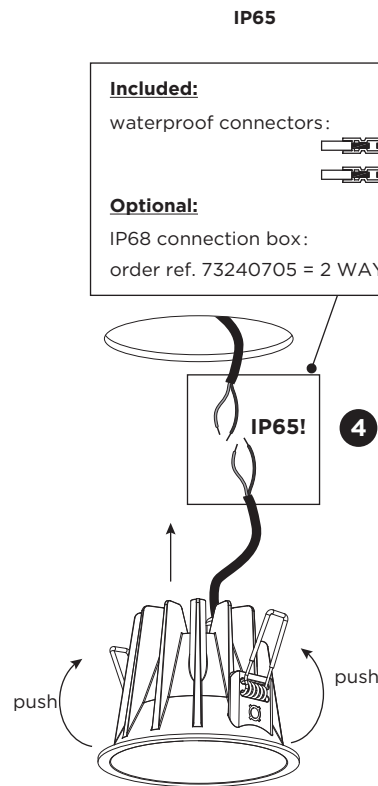

DEEP IP65

INSTALLATION INSTRUCTIONS | MARCH 2021

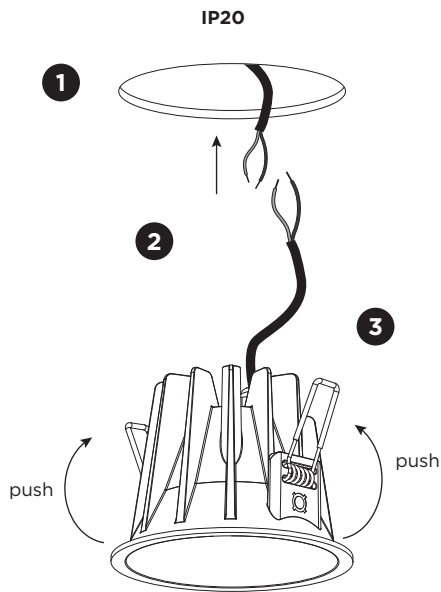

Included:
waterproof connectors:



Optional:
IP68 connection box:
order ref. 73240705 = 2 WAYS 2x0,75Ø4,8-6mm

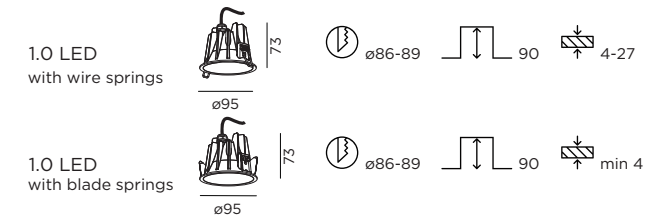

DIMENSIONS

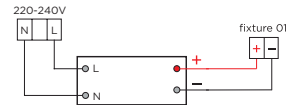

MOUNTING INSTRUCTION

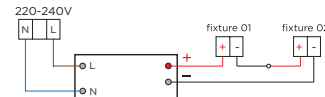
- 1 Make a hole in the ceiling according to the prescribed dimensions.
- 2 **POWER CONNECTION**
Always use a driver according to the specifications of the LED module/luminaire.
Single connection

Multiple connection

- 3 Push the springs up and insert the fixture in the ceiling hole.
- 4 Make sure to use a waterproof connection when the product needs to be IP65.

  Driver must be powered off before connecting cables.

Before connecting the luminaire/LED module to the driver please make sure the driver is not powered but disconnected from the mains. The driver can only be powered when the luminaire/LED module is already connected. Disregarding this instruction might damage or even destroy the luminaire/LED module.

