

STAKE FOLD

INSTALLATION INSTRUCTIONS | FEBRUARY 2022

5 OPTIONAL Mounting the snoot

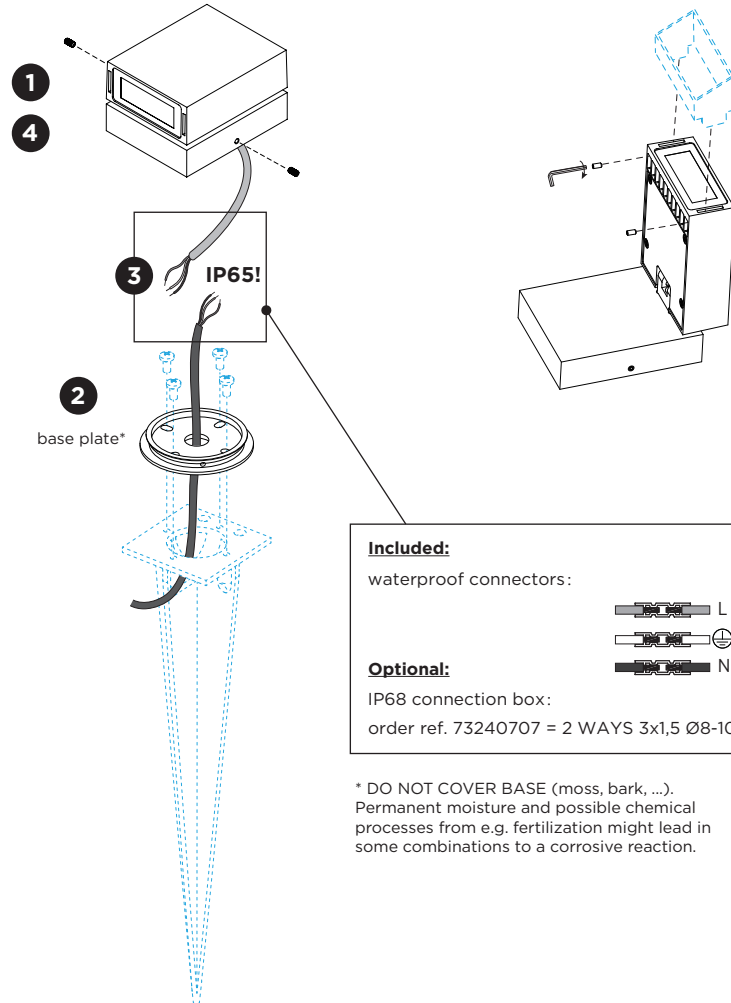

base plate

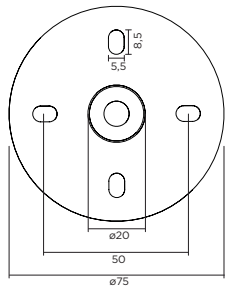

OPTIONAL
snoot dimensions
90019004

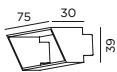

OPTIONAL
groundspike dimensions
90013107

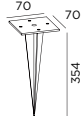

DIMENSIONS

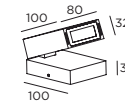

MOUNTING INSTRUCTION

- 1 Remove the base plate from the luminaire by loosening the side screws.
- 2 Fix the base plate to the surface (screws not included).
OPTIONAL
Fix the base plate to the groundspike (screws are included).
- 3 **POWER CONNECTION**
Connect the wires with waterproof connectors.
Connect to 220-240V.
Please see the detail method in the separate instruction sheet.
- 4 Attach the fixture back to the base plate with the side screws.
- 5 **OPTIONAL**
Mount the snoot on the Stake and lock it with the allen screws.

Included:

waterproof connectors:



Optional:

IP68 connection box:

order ref. 73240707 = 2 WAYS 3x1,5 Ø8-10mm

* DO NOT COVER BASE (moss, bark, ...).
Permanent moisture and possible chemical processes from e.g. fertilization might lead in some combinations to a corrosive reaction.

STAKE FOLD

INSTALLATION INSTRUCTIONS | FEBRUARY 2022

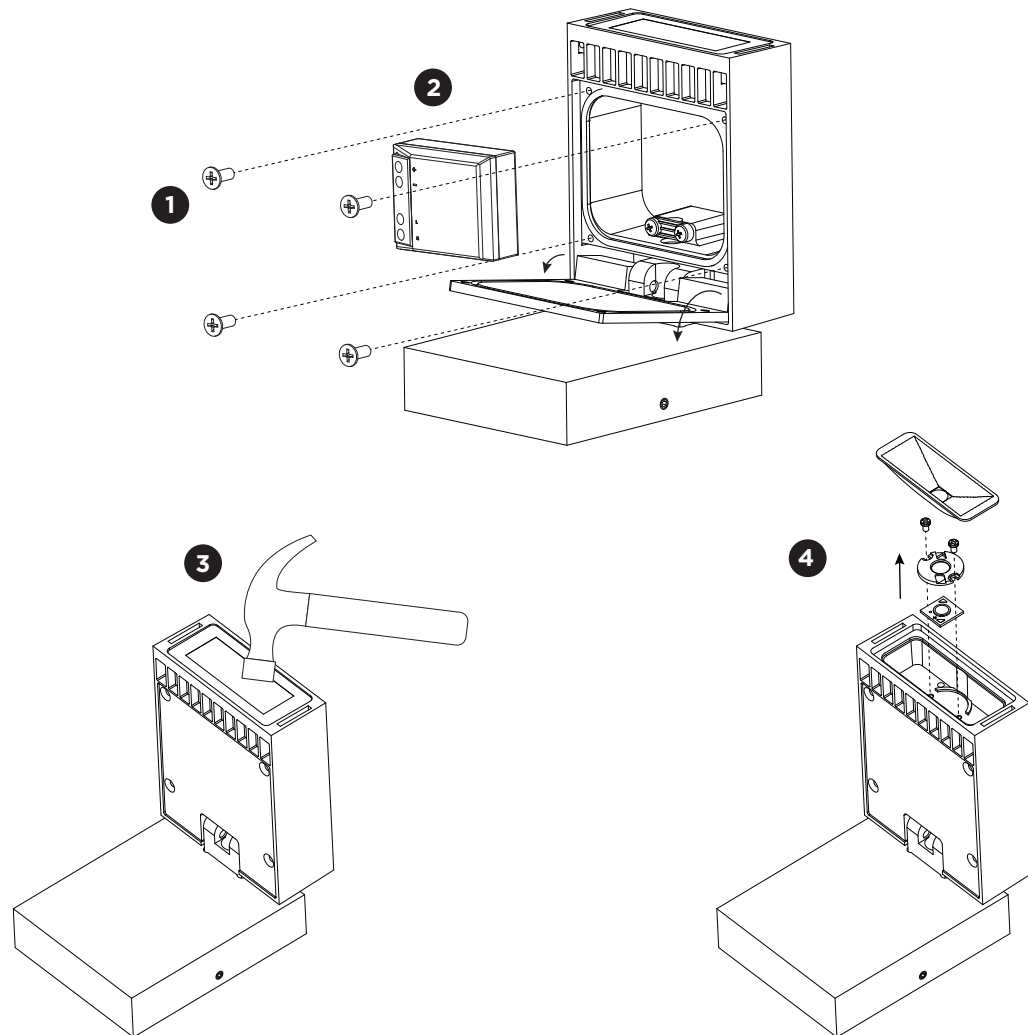

DISMOUNTING INSTRUCTION

Light source & driver

- 1** Loosen the screws and tilt the cover.
- 2** The driver can be removed by loosening the cables.
- 3** Break the glass.
- 4** Take out the reflector and unscrew the LED.

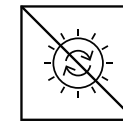

The light source is not replaceable.

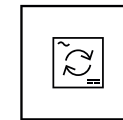

The driver can be replaced by the end user.



This luminaire contains a light source with the energy class F.