

- Only to be installed outside arms reach.

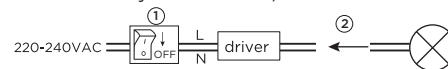

Driver must be powered off before connecting cables.

Before connecting the luminaire/LED module to the driver please make sure the driver is not powered but disconnected from the mains. The driver can only be powered when the luminaire/LED module is already connected. Disregarding this instruction might damage or even destroy the luminaire/LED module.



3 Push the springs upward and insert the fixture in the ceiling hole.

## DIMENSIONS

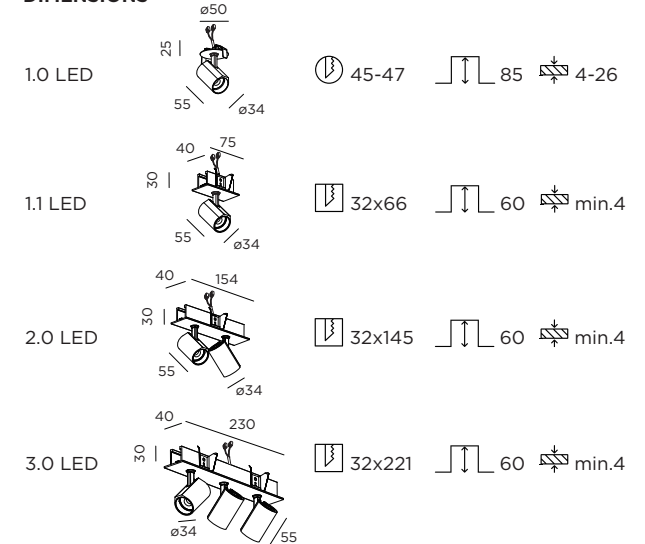

## MOUNTING INSTRUCTION

- 1 Make a hole in the ceiling according to the prescribed dimensions.
- 2 POWER CONNECTION

Always use a driver according to the specifications of the LED module.

### Single connection

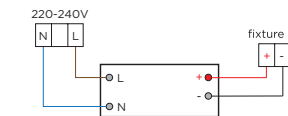

Connect to driver.



### Multiple connection

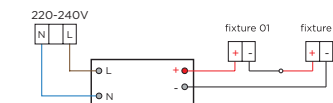

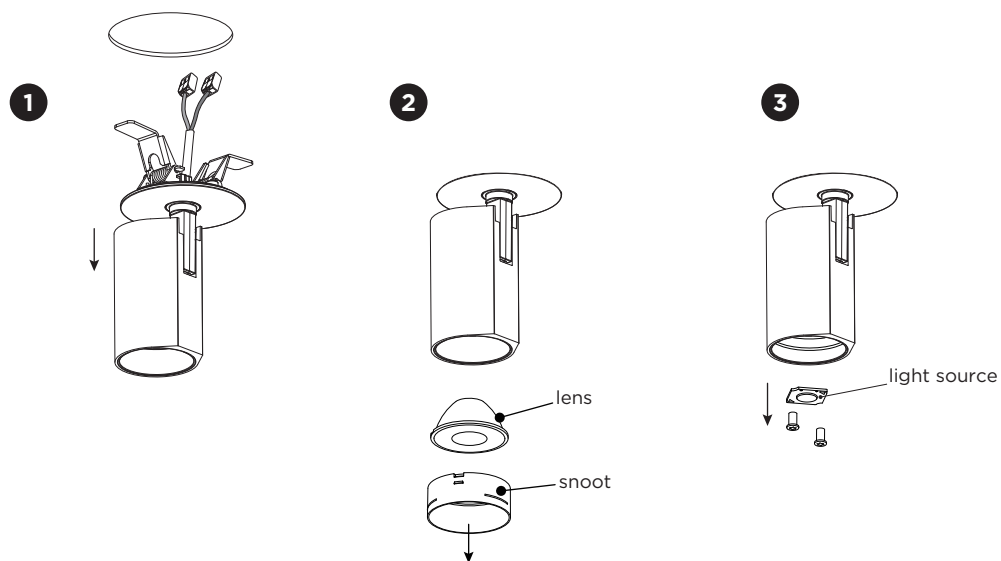

## DISMOUNTING AND RECYCLING INSTRUCTIONS

### Light source

- 1** Pull the fixture out from the ceiling and disconnect the connectors.
- 2** Pull out the snoot and lens.
- 3** Unscrew the screws and remove the light source.

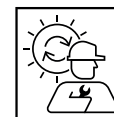

The light source is replaceable by an authorized professional.  
For advice contact your Wever & Ducré customer service contact point.



This luminaire contains a light source with the energy class E.